

BONALDO

Vague coffee table

Designer: **Roberto Paoli**



The Vague coffee table is a sculptural element that enriches the living area. The concrete base raises the metal upper section, which is available in different colours, in both a physical and figurative sense. The support top, with a curved and flowing shape that is similar to a raindrop, is ideal for

placing near the sofa. The proportions of the tops make the tables pleasantly decorative as well as functional island elements within the living space. The Vague coffee table is available in both high and low versions, which can be combined with each other.



Data sheet

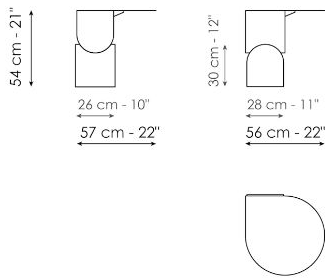

Vague coffee table high

Width: 57cm
Depth: 56cm
Height: 51cm

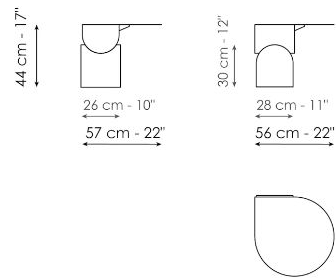

Vague coffee table low

Width: 57cm
Depth: 56cm
Height: 44cm

Finishes

TOP

Metal

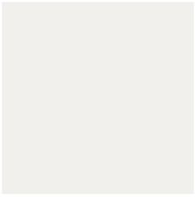

Painted metal
Mat white



Painted metal
Mat dove grey



Painted metal
Mat brown



Painted metal
Supreme anthracite



Painted metal
Mat black

Plus Metal



Painted metal
Mat brass



Painted metal
Mat copper



Painted metal
Mat bronze



Painted metal
Mat lead



Painted metal
Mat pearl gold

BASE

Concrete



Concrete
Travertin look



Concrete
Grey



Materials, fabrics, leathers, colors and finishes are approximate and may slightly differ from actual ones. You can find the complete collection of Bonaldo fabrics and leathers on the website

